



Patented Key Control Full Size Schlage Cylinders

Everest, the leading patented cylinder family from Schlage Lock Company. Whether you need convenient key duplication or restricted key control, Everest has a product to address your security issues. What sets Everest apart from the rest? Everest is a patent protected keying system that provides you as much key control as you need.

Patent Protected. The Everest product line is covered by utility patents to prevent manufacturing and distribution of aftermarket key blanks by anyone other than Schlage.

Everest Open Keyways. Four “open” keyways can be stocked by authorized Schlage dealers and sold to locksmiths for open duplication. End-users can have the convenience of going to the locksmith of their choice for additional locks, cylinders and keys.

Everest Restricted Keyways. Used where a higher degree of key control is needed. restricted blanks, cut keys and cylinders are furnished only through authorized Schlage distributors, with a letter of authorization from the end-user. Restricted items are drop shipped directly to the end-user or designated location, preventing locksmiths and distributors from having access to keys and cylinders without end-user’s permission. Restricted keyways will be randomly assigned to end-users, but are not offered with geographic exclusivity. End-users desiring this feature can step up to Schlage Primus high security key systems.

Schlage Quality. Schlage Lock is the only company that can legally supply Everest patented cylinders and keys. This guarantees locksmiths and end-users of original Schlage quality for every cylinder and key blank. Everest cylinders offer the same high quality standards you’ve come to expect from Schlage.

Strong Keys. The nickel silver key is 15% thicker to resist breakage, and the key bow is 25% larger for easier handling and customer marking.

Exploded View - Patented Full Size Cylinder

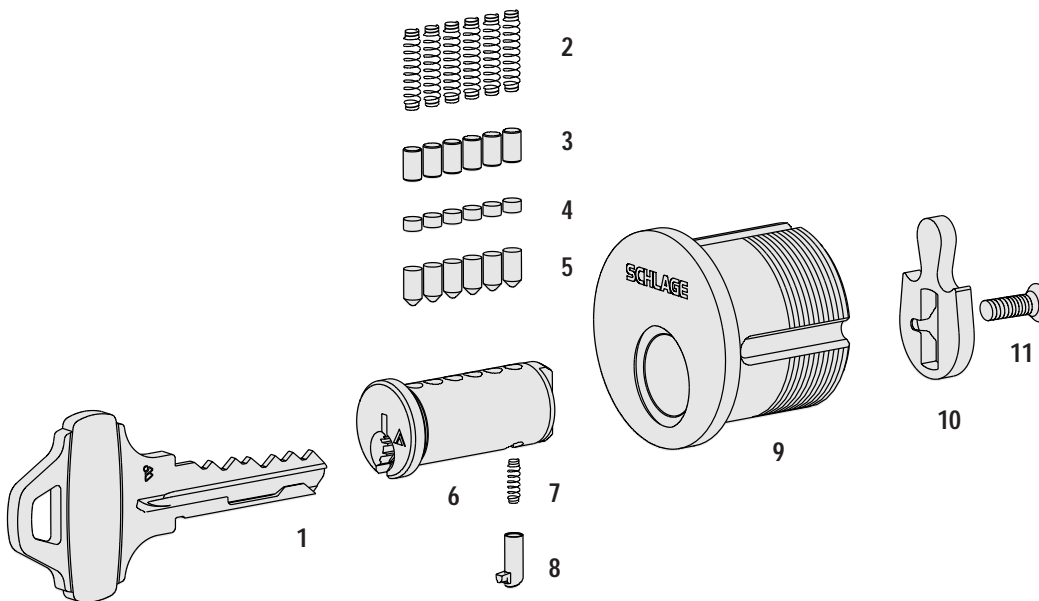

- | | | | |
|--------------------|----------------|---------------------|---------------|
| 1. Undercut groove | 4. Master pins | 7. Check pin spring | 10. Cam |
| 2. Tumbler springs | 5. Bottom pins | 8. Check pin | 11. Cam Screw |
| 3. Top pins | 6. Plug | 9. Shell | |

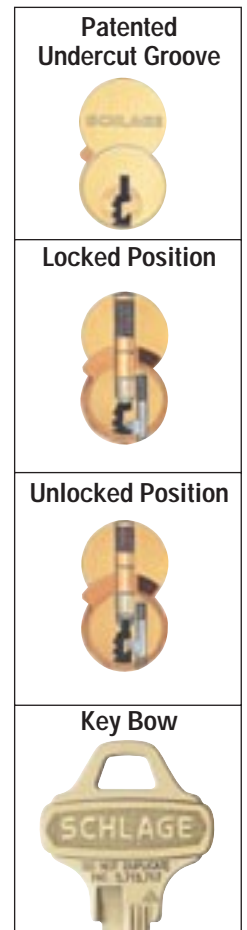

EVEREST™

Patented Key Control Full Size Schlage Cylinders

Performance Specifications

Applications. Schools, universities, hospitals, industrial sites, office, and commercial buildings, whether key control is a priority or not.

Keying. 6-Pin tumblers with two nickel silver keys per lock. Cylinders may be master or grand master keyed.

Benefits and Features

- Thicker, stronger keys. Larger key bow for ease of handling and customer stamping.
- Various patents to protect against unauthorized cylinder and key blank supply. This provides enhanced security and guarantees original Schlage quality.
- The current offering of Schlage locksets, finishes and functions is available with Everest patented cylinders, except hotel functions and letter box cylinders.
- Open and restricted keyways.
- No new ordering process. Everest is now the default for new master key systems.

Triad-C Open Multiplex Key System

Key Blanks

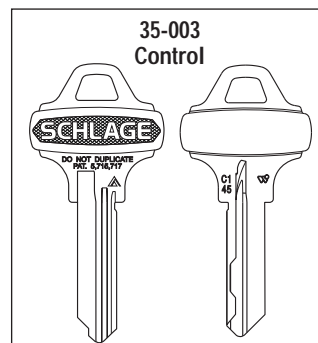
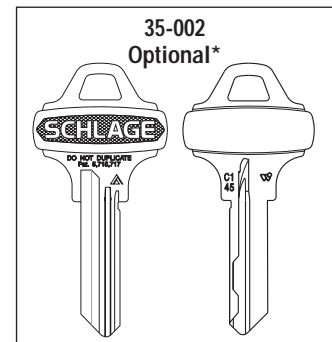
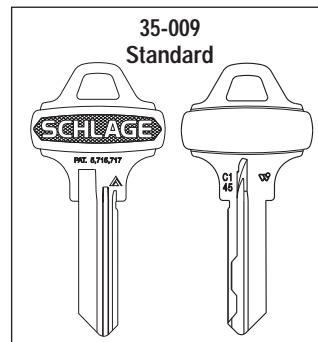

*Optional for Triad-C open keyways and standard for Triad-D restricted keyways.



SCHLAGE
2315 Briargate Parkway
Colorado Springs, CO 80920
719-264-5300
719-264-5474 Fax
www.schlage.com