

## Cylinder Assemblies

1371-3071	Cylinder Assembly	F
	<i>Includes screw pack (SRT standard – please specify other)</i>	
	<i>Size '1' cylinder is adjustable from size 1-5 (Parallel Arm 1-4)</i>	
1371-3071DEL	Delay Cylinder Assembly	F
	<i>Includes screw pack (SRT standard – please specify other)</i>	
	<i>Size '1' cylinder is adjustable from size 1-5 (Parallel Arm 1-4)</i>	

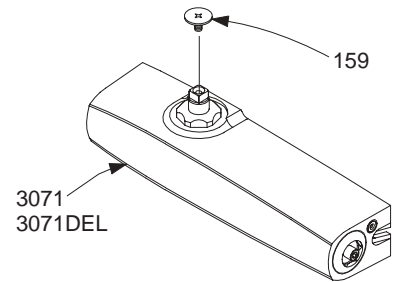

## Individual Cylinder Parts

Individual cylinder parts for 1371-3071

1370-159	Arm Screw	F
1370-119	Cylinder Mounting Screw	
1370-3018	Mounting Bracket	
	<i>Includes 1370-119</i>	

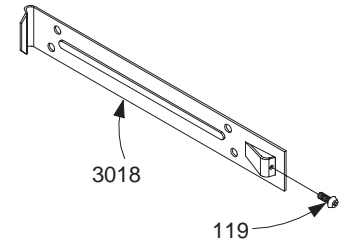

## Cover Caps

1370-72	End Caps & Shaft Cover Set	F
	<i>Includes 1370-141 (1), -146 (1), &amp; -334 (2)</i>	

## Individual Cover Parts

Individual cover parts for 1370-72

1370-141	Shaft Plug	F
1370-146	Shaft Cover	F
1370-334	End Cap	F

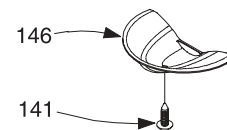
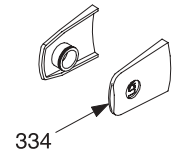

Please specify finish (**F**), size (**S**), hand (**H**), & voltage (**V**) where indicated. See the latest edition of the LCN Catalog for part descriptions and specifications on many of the items shown above. List prices for items shown above can be located in the current LCN Price List.

# LCN 1370 SERIES "Quest"

## Complete Arm Assemblies

1370-3077	Regular Arm	F
	<i>Includes 1370-77, -79, -83, &amp; -159</i>	
1370-3077L	Long Arm	F
	<i>Includes 1370-77, -79LR, -83, &amp; -159</i>	
1370-3077/PA	Regular Arm w/PA	F
	<i>Includes 1370-62PA, -77, -79, -83, 159, &amp; -201</i>	
1370-3077/62A	Regular Arm w/62A	F
	<i>Includes 1370-62A, -77, -79, -83, &amp; -159</i>	

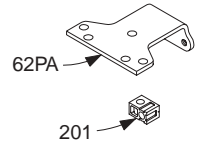
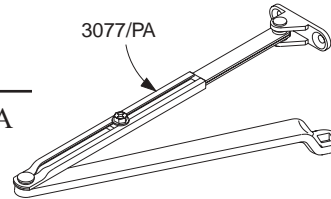
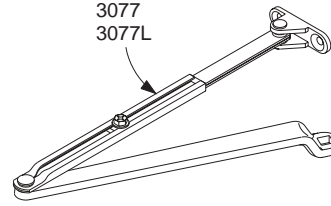

## Individual Arm Parts

Individual arm parts for 1370-3077, -3077L, -3077/PA, & -3077/62A

1370-62A	Auxiliary Parallel Arm Shoe	F
1370-62PA	Parallel Arm Shoe	F
	<i>Includes 1370-201</i>	
1370-77	Main Arm & Forearm	F
	<i>Includes 1370-159</i>	
1370-79	Rod & Shoe	F
	<i>Includes 1370-83 / Length is 8 3/8" (213mm)</i>	
1370-79LR	Long Rod & Shoe	F
	<i>Includes 1370-83 / Length is 12 3/8" (314mm)</i>	
1370-83	Arm Screw	F
1370-159	Arm Screw	F
1370-201	Fifth Screw Spacer	

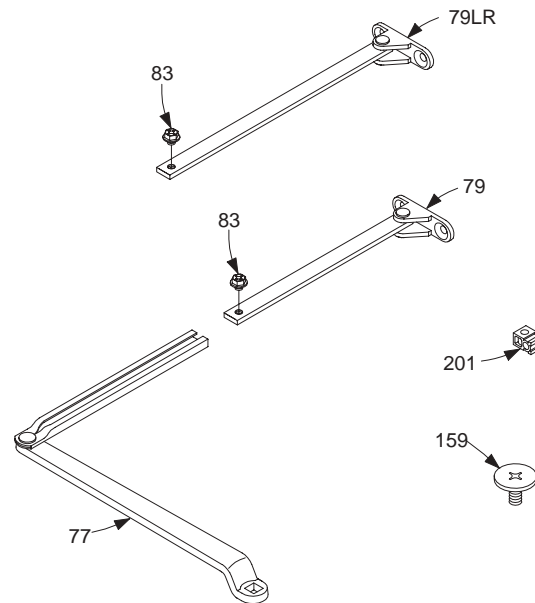
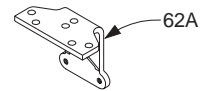
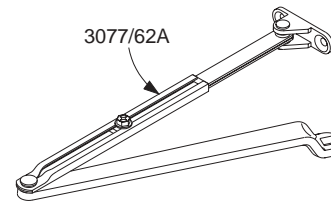

Please specify finish (F), size (S), hand (H), & voltage (V) where indicated. See the latest edition of the LCN Catalog for part descriptions and specifications on many of the items shown above. List prices for items shown above can be located in the current LCN Price List.

# LCN 1370 SERIES "Quest"

## Complete Arm Assemblies

1370-3049	Hold-Open Arm	F
	<i>Includes 1370-49, -83, -159, &amp; -3048</i>	
1370-3049/PA	Hold-Open Arm w/PA	F
	<i>Includes 1370-49, -62PA, -83, -159, &amp; -3048</i>	

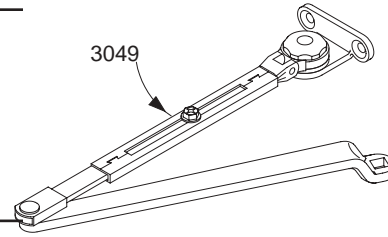

## Individual Arm Parts

Individual arm parts for 1370-3049, -3049/PA, & -3049/62A

1370-37	Hold-Open Stud	F
1370-41	Hold-Open Nut	F
1370-45	HO Shoe	F
1370-49	HO Main Arm & Rod	F
	<i>Includes 1370-83 &amp; -159</i>	
1370-62A	Auxiliary Parallel Arm Shoe	F
1370-62PA	Parallel Arm Shoe	F
	<i>Includes 1370-201</i>	
1370-78H	H Head & Tube	F
1370-83	Arm Screw	F
1370-159	Arm Screw	F
1370-201	Fifth Screw Spacer	F
1370-3048	HO Head & Tube Assy	F
	<i>Includes 1370-37, -41, -45, &amp; -78H</i>	
	<i>Length is 6 3/4" (171mm)</i>	

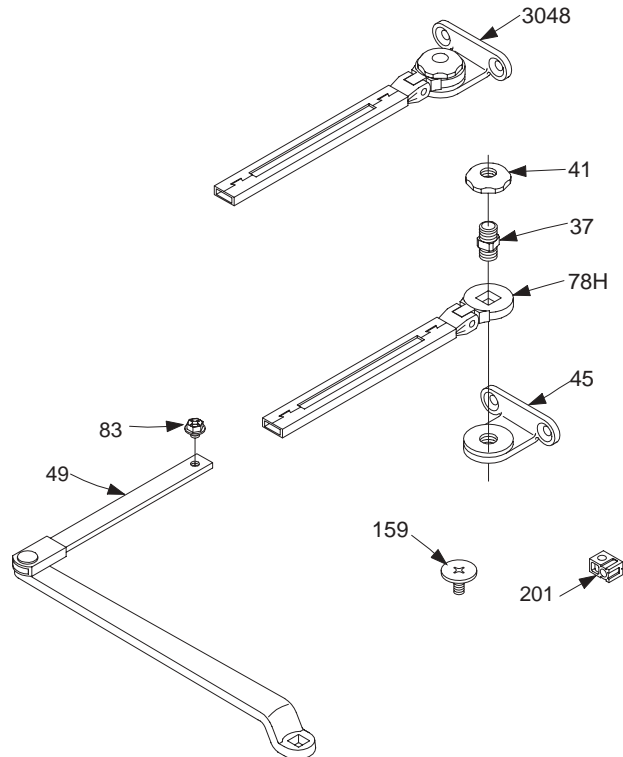
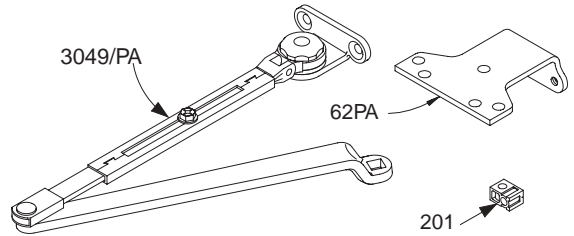

Please specify finish (F), size (S), hand (H), & voltage (V) where indicated. See the latest edition of the LCN Catalog for part descriptions and specifications on many of the items shown above. List prices for items shown above can be located in the current LCN Price List.

# LCN 1370 SERIES "Quest"

## Mounting Plates

1370-18	Mounting Plate	F
1370-18PA	Mounting Plate	F
1370-18TJ	Mounting Plate	F

## Installation Accessories

1370-61	Blade Stop Spacer	F
1370-63	Drop Shoe Bracket	F
1370-65	Soffit Shoe	F
1370-418	PA Shoe Adapter	F

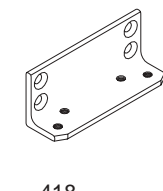
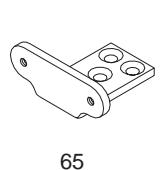
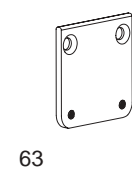
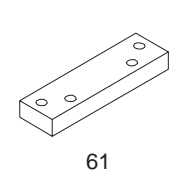
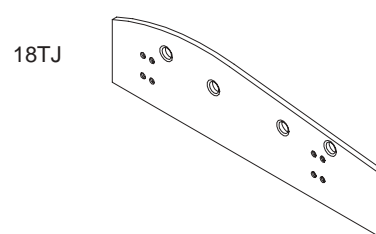
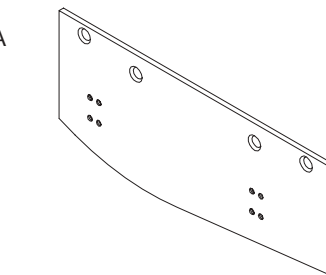
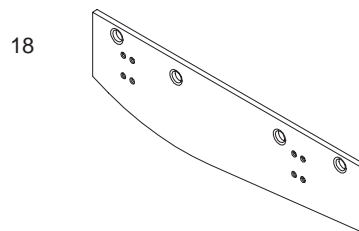

Please specify finish (F), size (S), hand (H), & voltage (V) where indicated. See the latest edition of the LCN Catalog for part descriptions and specifications on many of the items shown above. List prices for items shown above can be located in the current LCN Price List.